



Manufacturer:

Phonak LLC
4520 Weaver Parkway
Warrenville, IL 60555

www.phonak-us.com



029-0334-03/V2.00/2015-11/Printed in USA © Phonak US All rights reserved

Phonak Audéo V

(V90/V70/V50/V30)

User Guide



PHONAK
life is on

Contents

Your hearing aid	
1. Your hearing aid details	3
2. Welcome	4
3. Quick guide	6
4. Parts of the hearing aid	8
Using the hearing aid	
5. Left & right hearing aid markings	10
6. On/Off	11
7. Batteries	12
8. Putting on the hearing aid	14
9. Removing the hearing aid	15
10. Push button	16
11. Volume control	17
Further Information	
12. Care and maintenance	18
13. Wireless accessories	21
14. Service and warranty	22
15. Compliance information	24
16. Information and description of symbols	28
17. Troubleshooting	32
18. Important safety information	34
19. Important information: Cell phones	41
20. US market only, complies with FDA regulations	43
21. Important notice for Prospective Noise Generator users	47

1. Your hearing aid details

i If no box is checked and you do not know the model of your hearing aid, please ask your hearing care professional.

Model	Battery type
<input type="checkbox"/> Audéo V-10	<input type="checkbox"/> 10
<input type="checkbox"/> Audéo V-312	<input type="checkbox"/> 312
<input type="checkbox"/> Audéo V-312T	<input type="checkbox"/> 13
<input type="checkbox"/> Audéo V-13	

Your hearing care professional:

┐

┐

┐

┐

2. Welcome

Your new hearing aid was developed by Phonak, one of the world's leading companies in hearing technology. Your hearing aid offers the most modern digital hearing technology currently available on the market.

Please read these user instructions thoroughly in order to benefit from all the possibilities your new hearing aid has to offer. With proper use and care, you will be able to enjoy your hearing aid for many years to come.

If you have any questions, please consult your hearing care professional.

Phonak - life is on
www.phonak-us.com

Download the Phonak Support App

To have an individual and interactive user guide always with you, download the Phonak Support App on your mobile device. For more information please visit: www.phonak-us.com/supportapp



This user guide is valid for:

Wireless models

Phonak Audéo V90-10	2014
Phonak Audéo V90-312	2014
Phonak Audéo V90-312T	2014
Phonak Audéo V90-13	2014
Phonak Audéo V70-10	2014
Phonak Audéo V70-312	2014
Phonak Audéo V70-312T	2014
Phonak Audéo V70-13	2014
Phonak Audéo V50-10	2014
Phonak Audéo V50-312	2014
Phonak Audéo V50-312T	2014
Phonak Audéo V50-13	2014
Phonak Audéo V30-10	2014
Phonak Audéo V30-312	2014
Phonak Audéo V30-312T	2014
Phonak Audéo V30-13	2014

CE mark applied

3. Quick guide

Left & right hearing aid markings

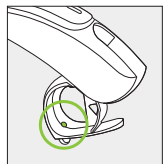

Audéo V-10, V-312,
V-312T

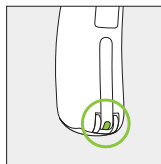

Audéo V-13

Blue marking for **left**
hearing aid.

Red marking for **right**
hearing aid.

Changing batteries

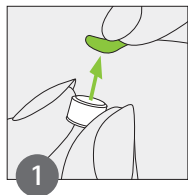

1
Remove the
sticker from the
new battery.

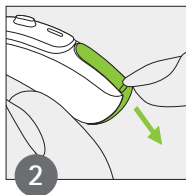

2
Open the
battery door.

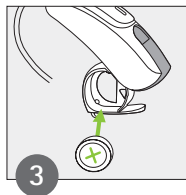

3
Place battery in
the battery door
with the "+"
symbol facing
upwards.

On/Off

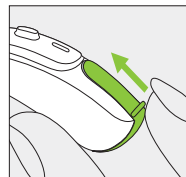

On

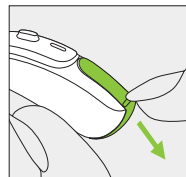

Off

Push button

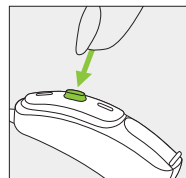

The push button on your hearing aid can have various functions. The function for your hearing aid is indicated in your individual instructions.

Volume control

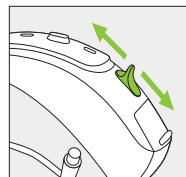

To increase the volume, press the volume control upwards. To decrease the volume, press the volume control downwards.

4. Parts of the hearing aid

The pictures below show the models described in this user guide. You can identify your personal model by:

- Checking "Your hearing aid details" in chapter 1.
- Or comparing your hearing aid with the models shown below. Pay attention to the shape of the hearing aid and if a volume control is present.

Audéo V-10

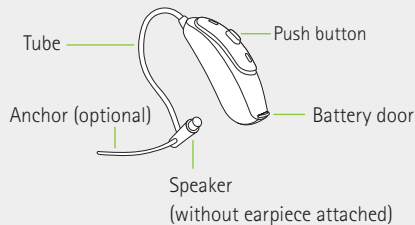

Audéo V-312 & V-312T

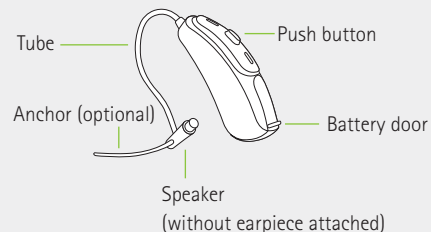

Audéo V-13

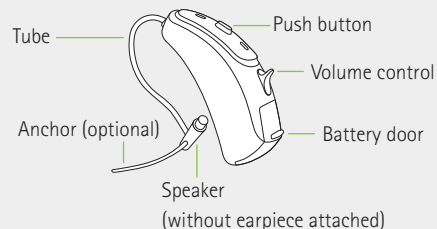

5. Left & right hearing aid markings

1

Open the battery door. To do this, pull down on the ridge at the bottom of the hearing aid.

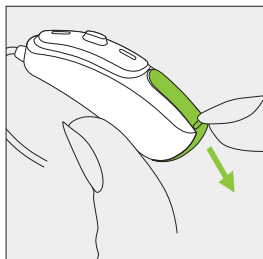

2

There is a red or blue marking inside the battery door. This will tell you if it is a left or a right hearing aid.

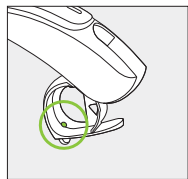

Audéo V-10, V-312,
V-312T

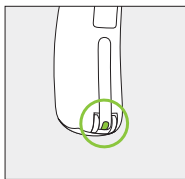

Audéo V-13

Blue marking
for **left**
hearing aid.

Red marking
for **right**
hearing aid.

6. On/Off

The battery door is also the on/off switch.

1

Closed battery door =
hearing aid is **on**

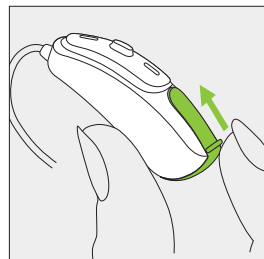

2

Open battery door =
hearing aid is **off**

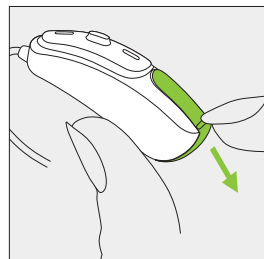

i When you switch on the hearing aid you may hear a start-up melody.

7. Batteries

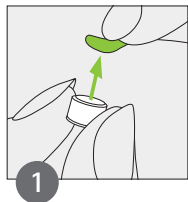

1
Remove the sticker from the new battery and wait 2 minutes.

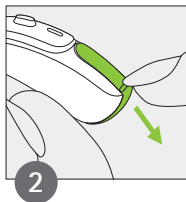

2
Open the battery door.

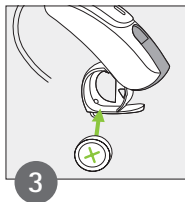

3
Place battery in the battery door with the "+" symbol facing upwards.

i If it is difficult to close the battery door: Check the battery is inserted correctly and the "+" symbol is facing upwards. If the battery is not inserted correctly, the hearing aid will not work and the battery door can be damaged.



Low power: You will hear two beeps when the battery is low. You will have approximately 30 minutes to change the battery (this can vary, depending on the

hearing aid settings and battery). We recommend that you always have a new battery on hand.

Replacement battery

This hearing aid requires zinc-air batteries. Identify the correct battery size (10, 312 or 13) by:

- Checking "Your hearing aid details" in chapter 1.
- Checking the marking on the inner side of the battery door.
- Or checking the following table.

Model	Zinc air battery size	Color marking on package	IEC code	ANSI code
Phonak Audéo				
V-312, V-312T	312	brown	PR41	7002ZD
V-10	10	yellow	PR70	7005ZD
V-13	13	orange	PR48	7000ZD

i Please ensure you use the correct type of battery in your hearing aids (zinc-air). Please also read chapter 18.2 for further information on product safety.

8. Putting on the hearing aid

1

Place the hearing aid behind your ear.

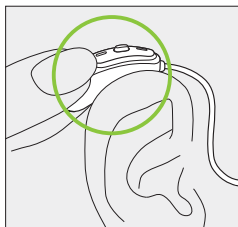

2

Insert the earpiece into your ear canal.

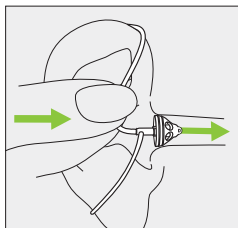

3

If there is an anchor attached to the earpiece, tuck it into the bowl of your ear to secure your hearing aid.

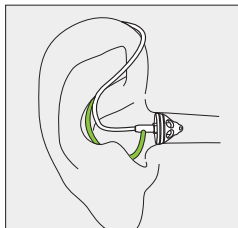

9. Removing the hearing aid

1

Pull on the bend of the tube and remove the hearing aid from behind the ear.

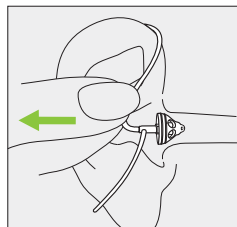

In very rare cases, your earpiece can remain in your ear canal when removing the hearing aid from the ear. In the unlikely case that the earpiece does get stuck in your ear canal, it is strongly recommended to see a medical specialist for safe removal.

10. Push button

The push button on your hearing aid can have various functions or is not active. This depends on the programming of the hearing aid, which is indicated in your individual "Hearing aid instructions". Please ask your hearing care professional for this printout.

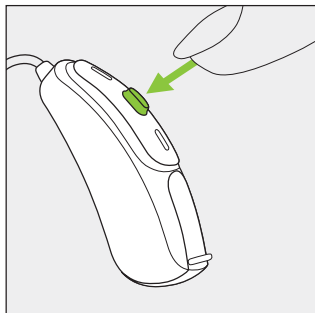

11. Volume control

To increase the volume, press the volume control upwards. To decrease the volume, press the volume control downwards. The volume control can be disabled by the hearing care professional.

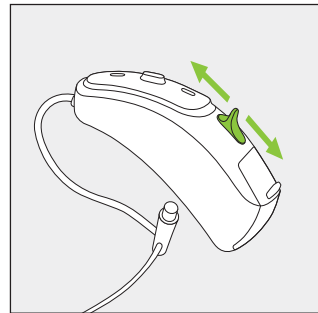

12. Care and maintenance

Diligent and routine care of your hearing aid contributes to outstanding performance and a long service life.

Please use the following specifications as a guideline. Further information regarding product safety, see chapter 18.2.

General information

Before using hair spray or applying cosmetics, you should remove your hearing aid from your ear, because these products may damage it.

When you are not using your hearing aid, leave the battery door open so that any moisture can evaporate. Make sure that you always completely dry your hearing aid after use. Store the hearing aid in a safe, dry and clean place.

Your hearing aids are resistant to water, sweat and dust under the following conditions:

- The battery door is fully closed. Ensure that no foreign object such as hair is caught in the battery door when it is closed.
- After exposure to water, sweat or dust, the hearing aid is cleaned and dried.
- The hearing aid is used and maintained as described in this user guide.

- ① Hearing aids with the design-integrated Roger receiver are also water resistant.
- ① Hearing aids with an audio shoe and Roger universal receiver are not water resistant.
- ① Use of your hearing aid around water can restrict air flow to the batteries causing it to stop working. Should your hearing aid stop working after coming into contact with water, refer to the troubleshooting steps in chapter 17.

Daily

Inspect the earpiece for earwax and moisture deposits. Clean the surfaces with a lint-free cloth. Never use cleaning agents such as household detergents, soap, etc. for cleaning your hearing aid. It is not recommended to rinse with water. If you need to clean your hearing aid intensively, ask your hearing care professional for advice and information on filters or drying capsules.

Weekly

Clean the earpiece with a soft, damp cloth or with a special cleaning cloth for hearing aids. For more in depth maintenance instructions or for more than basic cleaning, please see your hearing care professional.

13. Wireless accessories

A range of Phonak accessories are available for you to use with your hearing aid.

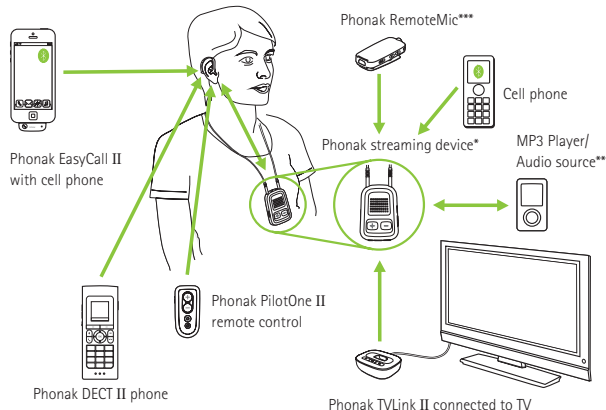

* The Phonak ComPilot II with neckloop or ComPilot Air II with clip to attach to clothing. They also have basic remote control functionalities. For advanced control they can be used with the Phonak RemoteControl App.

** Audio sources (e.g. MP3 Player, computer, laptop, tablet) can be connected to the streaming device via Bluetooth or audio cable.

*** Clipped onto the speaker's clothing for better understanding over distance.

14. Service and warranty

Local warranty

Please ask the hearing care professional, where you purchased your hearing aid, about the terms of the local warranty.

International warranty

Phonak offers a one year limited international warranty, valid starting from the date of purchase. This limited warranty covers manufacturing and material defects in the hearing aid itself, but not accessories such as batteries, tubes, earmolds, external receivers. The warranty only comes into force if a proof of purchase is shown.

The international warranty does not affect any legal rights that you might have under applicable national legislation governing sale of consumer goods.

Warranty limitation

This warranty does not cover damage from improper handling or care, exposure to chemicals or undue stress. Damage caused by third parties or non-authorized service centers renders the warranty null and void. This warranty does not include any services performed by a hearing care professional in their office.

Serial number (left side):	Authorized hearing care professional (stamp/signature):
-------------------------------	--

Serial number
(right side):

Date of purchase:

15. Compliance information

Europe:

Declaration of Conformity

Hereby Phonak AG declares that this Phonak product meets the requirements of the Medical Devices Directive 93/42/EEC as well as the Radio and Telecommunications Terminal Equipment Directive 1999/5/EC. The full text of the Declaration of Conformity can be obtained from the manufacturer or the local Phonak representative whose address can be taken from the list on www.phonak.com (Phonak worldwide locations).

Australia:

Supplier Code Number	 N15398
----------------------	--

New Zealand:

Supplier Code Number	Z1285
----------------------	-------

The wireless models listed in chapter 2 are certified under:

Phonak Audéo V-10

USA	FCC ID: KWC-WHSRIC1
Canada	IC: 2262A-WHSRIC1

Phonak Audéo V-312

USA	FCC ID: KWC-WHSRIC2
Canada	IC: 2262A-WHSRIC2

Phonak Audéo V-312T

USA	FCC ID: KWC-WHSRIC3
Canada	IC: 2262A-WHSRIC3

Phonak Audéo V-13

USA	FCC ID: KWC-WHSRIC4
Canada	IC: 2262A-WHSRIC4

Notice 1:

This device complies with Part 15 of the FCC Rules and with RSS-210 of Industry Canada. Operation is subject to the following two conditions:

- 1) this device may not cause harmful interference, and
- 2) this device must accept any interference received, including interference that may cause undesired operation.

Notice 2:

Changes or modifications made to this device not expressly approved by Phonak may void the FCC authorization to operate this device.

Notice 3:

This device has been tested and found to comply with the limits for a Class B digital device, pursuant to Part 15 of the FCC Rules and ICES-003 of Industry Canada. These limits are designed to provide reasonable protection against harmful interference in a residential installation. This device generates, uses and can radiate radio frequency energy and, if not installed and used in accordance with the instructions, may cause harmful interference to radio communications. However, there is

no guarantee that interference will not occur in a particular installation. If this device does cause harmful interference to radio or television reception, which can be determined by turning the equipment off and on, the user is encouraged to try to correct the interference by one or more of the following measures:

- Reorient or relocate the receiving antenna.
- Increase the separation between the device and receiver.
- Connect the device into an outlet on a circuit different from that to which the receiver is connected.
- Consult the dealer or an experienced radio/TV technician for help.

16. Information and description of symbols



With the CE symbol, Phonak AG confirms that this Phonak product – including accessories – meets the requirements of the Medical Devices Directive 93/42/EEC as well as the R&TTE Directive 1999/5/EC on radio and telecommunications equipment. The numbers after the CE symbol correspond to the code of certified institutions that were consulted under the above-mentioned directives.



This symbol indicates that the products described in these user instructions adhere to the requirements for an applied part of Type B of EN 60601-1. The surface of the hearing aid is specified as an applied part of Type B.



Indicates the medical device manufacturer, as defined in EU Directive 93/42/EEC.



EMC and Radio communications compliance label Australia.



This symbol indicates that it is important for the user to read and take into account the relevant information in these user guides.



This symbol indicates that it is important for the user to pay attention to the relevant warning notices in these user guides.



Important information for handling and product safety.

Operating conditions

The product is designed such that it functions without problems or restrictions if used as intended, unless otherwise noted in these user guides.



Temperature during transportation and storage: -20° to $+60^{\circ}$ Celsius (-4° to $+140^{\circ}$ Fahrenheit).



Humidity during transportation: Up to 90% (non condensing). Humidity during storage: 0% to 70%, if not in use. See instruction in chapter 18.2 regarding drying the hearing aid after use.



Atmospheric pressure: 200 hPa to 1500 hPa



The symbol with the crossed-out garbage bin is to make you aware that this hearing aid may not be thrown away as normal household waste. Please dispose of old or unused hearing aids, at waste disposal sites intended for electronic waste, or give your hearing aid to your hearing care professional for disposal. Proper disposal protects the environment and health.

17. Troubleshooting

Problem	Causes	What to do
Hearing aid not functioning	Dead battery	Change battery (chapter 3 + 7)
	Blocked speaker/earpiece	Clean speaker opening/earpiece
	Battery not inserted correctly	Insert battery correctly (chapter 3 + 7)
	Hearing aid switched off	Switch hearing aid on by completely closing the battery door (chapter 6)
Hearing aid whistles	Hearing aid not inserted correctly	Insert hearing aid correctly (chapter 8)
	Cerumen in ear canal	Contact your ENT/GP or hearing care professional
Hearing aid not loud enough or distorted	Volume too loud	Decrease volume (chapter 10 + 11)
	Low battery	Change battery (chapter 3 + 7)
	Speaker/earpiece blocked	Clean speaker opening/earpiece
	Volume too low	Turn volume up if volume control available (chapter 10 + 11)
	Hearing has changed	Contact you hearing care professional
Hearing aid plays two beeps	Indication for low battery	Change battery within the next 30 minutes (chapter 3 + 7)
Hearing aid switches on & off (intermittent)	Moisture on battery or hearing aid	Wipe battery and hearing aid with dry cloth





 If the problem persists, contact you hearing care professional for assistance

18. Important safety information

Please read the information on the following pages before using your hearing aid.

A hearing aid will not restore normal hearing and will not prevent or improve a hearing impairment resulting from organic conditions. Infrequent use of a hearing aid does not permit a user to attain full benefit from it. The use of a hearing aid is only part of hearing habilitation and may need to be supplemented by auditory training and instruction in lipreading.

18.1 Hazard warnings

-  The intended use of hearing aids is to amplify and transmit sound to the ears and hereby compensate for impaired hearing. The hearing aids (specially programmed for each hearing loss) must only be used by the intended person. They should not be used by any other person as they could damage hearing.
-  Changes or modifications to the hearing aid that were not explicitly approved by Phonak are not permitted. Such changes may damage your ear or the hearing aid.
-  Do not use the hearing aids in explosive areas (oxygen-rich environments, mines or industrial areas with danger of explosions).
-  Hearing aid batteries are toxic if they are swallowed! Keep out of reach of children under 3 years. If batteries are swallowed, consult your physician immediately!

 If you feel pain in or behind your ear, if it is inflamed or if skin irritation and accelerated accumulations of earwax occur, please check with your hearing care professional or physician.

 In very rare cases, the dome can remain in your ear canal when removing the hearing tube from the ear. In the unlikely case that the dome does get stuck in your ear canal, it is strongly recommended to see a physician for safe removal.

 Hearing programs in the directional microphone mode reduce background noises. Please be aware that warning signals or noises coming from behind, e. g. cars, are partially or entirely suppressed.

 This hearing aid is not for children below 36 months. It contains small parts that can cause choking, if swallowed by children. Keep out of reach of children and mentally challenged people or pets. If swallowed, consult a physician or hospital immediately.

 External devices may only be connected if they have been tested in accordance with corresponding IECXXXXX standards. Only use accessories approved by Phonak AG, to avoid any electrical shock.

 The following is only applicable for persons with active implantable medical devices (i.e. pacemakers, defibrillators, etc.):

- Keep the wireless hearing aid at least 15 cm (6 inches) away from the active implant. If you experience any interference, do not use the wireless hearing aids and contact the manufacturer of the active implant. Please, note

that interference can also be caused by power lines, electrostatic discharge, airport metal detectors etc.

- Keep magnets (i.e. battery handling tool, EasyPhone magnet, etc.) at least 15 cm (6 inches) away from the active implant.

18.2 Information on product safety

- ❗ Phonak hearing aids are water resistant and not waterproof. They are designed to withstand normal activities and occasional accidental exposure to extreme conditions. Never immerse your hearing aid in water! Phonak hearing aids are not specifically designed for extended periods of water submersion on a continual basis, that is worn in activities such as swimming or bathing. Always remove your hearing aid before these activities, as the hearing aid contains sensitive electronic parts.
- ❗ Never wash the microphone inputs. Doing so could cause it to lose its special acoustic features.
- ❗ Protect your hearing aid from heat (never leave near a window or in the car). Never use a microwave or other heating devices to dry your hearing aid. Ask your hearing care professional about suitable drying methods.
- ❗ When you are not using your hearing aid, leave the battery door open so that any moisture can evaporate. Make sure that you always completely dry your

hearing aid after use. Store the hearing aid in a safe, dry and clean place.

- ❗ Do not drop your hearing aid! Dropping onto a hard surface can damage your hearing aid.
- ❗ Always use new batteries for your hearing aid. In case a battery is leaking, replace it immediately with a new one to avoid any skin irritation. You can return used batteries to your hearing care professional.

- ❗ The batteries used in these hearing aids should not exceed 1.5 Volts. Please do not use silver-zinc or Li-ion (lithium-ion) rechargeable batteries as these may cause severe damage to your hearing aids. The table in chapter 7 explains exactly which type of battery your particular hearing aids require.
- ❗ Remove the battery if you are not using your hearing aid for a long period of time.

❗ Special medical or dental examination including radiation described below, may adversely affect the correct functioning of your hearing aids. Remove and keep them outside the examination room/area before undergoing:

- Medical or dental examination with X-ray (also CT scan).
- Medical examinations with MRI/NMRI scans, generating magnetic fields.
- Hearing aids don't need to be removed when passing security gates (airports etc.). If X-ray is used at all, it will be in very low doses, and will not affect the hearing aids.

❗ Do not use your hearing aid in areas where electronic equipment is prohibited.

19. Important information: Cell phones

Some hearing aid users have reported a buzzing sound in their hearing aids when they are using cell phones. According to the ANSI 63.19 (American National Standard Methods of Measurement of Compatibility between Wireless Communications Devices and Hearing Instruments) standard, the compatibility of a particular hearing aid and cell phone can be predicted by adding the rating for the hearing aid immunity to the rating for the cell phone emissions. The sum of the hearing aid rating (e.g. M2/T2=2) and the telephone rating (e.g. M3/T3=3) is 5, and any combination that equals 5 will provide "normal use"; a sum of 6 or greater would indicate "excellent performance". The equipment performance measurements, categories and system classifications are based upon the best information available but cannot guarantee that all users will be satisfied. The immunity of this hearing aid is at least M2/T2.

Note: the performance of individual hearing aids may vary with individual cell phones. Therefore, please try the hearing aid with your cell phone or, if you are purchasing a new phone, be sure to try it with your hearing aid prior to purchase. For additional guidance, please ask your hearing care professional for the booklet entitled "hearing aid compatibility with digital wireless cell phones".

20. For the US market only, complies with the FDA regulations

Warning to Hearing Aid Dispensers

A hearing aid dispenser should advise a prospective hearing aid user to consult promptly with a licensed physician (preferably an ear specialist) before dispensing a hearing aid if the hearing aid dispenser determines through inquiry, actual observation, or review of any other available information concerning the prospective user, that the prospective user has any of the following conditions:

- (i) Visible congenital or traumatic deformity of the ear.
- (ii) History of active drainage from the ear within the previous 90 days.
- (iii) History of sudden or rapidly progressive hearing loss within the previous 90 days.
- (iv) Acute or chronic dizziness.
- (v) Unilateral hearing loss of sudden or recent onset within the previous 90 days.

-
- (vi) Audiometric air-bone gap equal to or greater than 15 decibels at 500 hertz (Hz), 1,000 Hz, and 2,000 Hz.
 - (vii) Visible evidence of significant cerumen accumulation or a foreign body in the ear canal.
 - (viii) Pain or discomfort in the ear. Special care should be exercised in selecting and fitting a hearing aid whose maximum sound pressure level exceeds 132 decibels because there may be risk of impairing the remaining hearing of the hearing aid user. (This provision is required only for those hearing aids with a maximum sound pressure capability greater than 132 decibels (dB).)

Important Notice for Prospective Hearing Aid Users

Good health practice requires that a person with a hearing loss have a medical evaluation by a licensed physician (preferably a physician who specializes in diseases of the ear) before purchasing a hearing aid. Licensed physicians who specialize in diseases of the ear are often referred to as otolaryngologists, otologists or otorhinolaryngologists. The purpose of medical evaluation is to assure that all

medically treatable conditions that may affect hearing are identified and treated before the hearing aid is purchased.

Following the medical evaluation, the physician will give you a written statement that states that your hearing loss has been medically evaluated and that you may be considered a candidate for a hearing aid. The physician will refer you to an audiologist or a hearing aid dispenser, as appropriate, for a hearing aid evaluation.

The audiologist or hearing aid dispenser will conduct a hearing aid evaluation to assess your ability to hear with and without a hearing aid. The hearing aid evaluation will enable the audiologist or dispenser to select and fit a hearing aid to your individual needs.

If you have reservations about your ability to adapt to amplification, you should inquire about the availability of a trial-rental or purchase-option program. Many hearing aid dispensers now offer programs that permit you to wear a hearing aid for a period of time for a nominal fee after which you may decide if you want to purchase the hearing aid.

Federal law restricts the sale of hearing aids to those individuals who have obtained a medical evaluation from a licensed physician. Federal law permits a fully informed adult to sign a waiver statement declining the medical evaluation for religious or personal beliefs that preclude consultation with a physician. The exercise of such a waiver is not in your best health interest and its use is strongly discouraged.

Children with Hearing Loss

In addition to seeing a physician for a medical evaluation, a child with a hearing loss should be directed to an audiologist for evaluation and rehabilitation since hearing loss may cause problems in language development and the educational and social growth of a child. An audiologist is qualified by training and experience to assist in the evaluation and rehabilitation of a child with a hearing loss.

21. Important notice for Prospective Noise Generator users

The Tinnitus Balance noise generator is a broadband sound Generator which may have been enabled in your hearing aid. It provides a means of sound enrichment that can be used as part of a personalized tinnitus management program to provide temporary relief from tinnitus. It should always be used as prescribed by your audiologist. The underlying principle of sound enrichment is to provide supplementary noise stimulation which can help defocus your attention from your tinnitus and avoid negative reactions. Sound enrichment, coupled with instructional counseling, is an established approach to managing tinnitus.

Good health practice requires that a person reporting tinnitus have a medical evaluation by a licensed ear physician before using a sound generator. The purpose of such an evaluation is to ensure medically treatable conditions that may be causing tinnitus are identified and treated prior to using a sound generator.

Should you develop any side effects whilst using the noise generator such as headaches, nausea, dizziness or heart palpitations or experience a decrease in auditory function, you should discontinue use and seek a medical evaluation.

According to OSHA (Occupational Safety & Health Administration, U.S. Department of Labor) regulations, the volume of the noise generator can be set to a level which could lead to permanent hearing damage when used for a prolonged period of time. Should the noise generator be set to such a level in your hearing aid, your audiologist will advise you of the maximum amount of time per day you should use the noise generator. The noise generator should never be used at uncomfortable levels.

Notes

[illegible][illegible]